

1045 Bronze Vertical Lift Check Valve (Screwed) ^{I.B.R}

Salient Features

- Screwed Female Ends to BSPT.
- Renewable 13% Cr. Stainless Steel (S.S 410) working parts.
- Two Piece Design.

Test Pressure (Hydrostatic) :
Shell 35.15 kg/cm²g (500 psig)
Working Pressure (Steam) : 17.58 kg/cm²g (250 psig)
Maximum Working Temperature : 225°C

Suitable For

Steam, Water



Materials

P.No.	Name of Part	Material of Construction	Specification	Quantity
1	Outlet Body	Bronze	IBR 282 (a) (iv) Gr. B	1
2	Disc	Stainless Steel	ASTM A276 Type 410	1
3	Body Seat Ring	Stainless Steel	ASTM A276 Type 410	1
4	Inlet Body	Bronze	IBR 282 (a) (iv) Gr. B	1

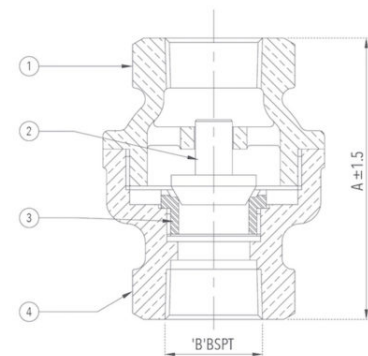

Sizes / Dimensions

Size (Inches)	Size (mm)	A ±1.5	B
1/2	15	73	1/2"
3/4	20	76	3/4"
1	25	90	1"
1 1/4	32	114	1 1/4"
1 1/2	40	127	1 1/2"
2	50	152	2"