

1046 Bronze Vertical Lift Check Valve (Flanged)

I.B.R

Salient Features

- Flanged Ends to BS 10 Table 'H'.
- Renewable 13% Cr. Stainless Steel (S.S 410) working parts.
- Two Piece Design.

Test Pressure (Hydrostatic) :

Shell : 35.15 kg/cm²g (500 psig)

Working Pressure (Steam) : 17.58 kg/cm²g (250 psig)

Maximum Working Temperature : 225°C

Suitable For

Steam, Water



Materials

P.No.	Name of Part	Material of Construction	Specification	Quantity
1	Outlet Body	Bronze	IBR 282 (a) (iv) Gr. B	1
2	Disc	Stainless Steel	ASTM A276 Type 410	1
3	Body Seat Ring	Stainless Steel	ASTM A276 Type 410	1
4	Inlet Body	Bronze	IBR 282 (a) (iv) Gr. B	1

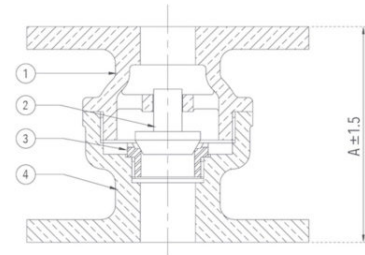

Sizes / Dimensions

Size (Inches)	Size (mm)	A ± 1.5
1/2	15	70
3/4	20	76
1	25	95
1 1/4	32	102
1 1/2	40	123
2	50	140